

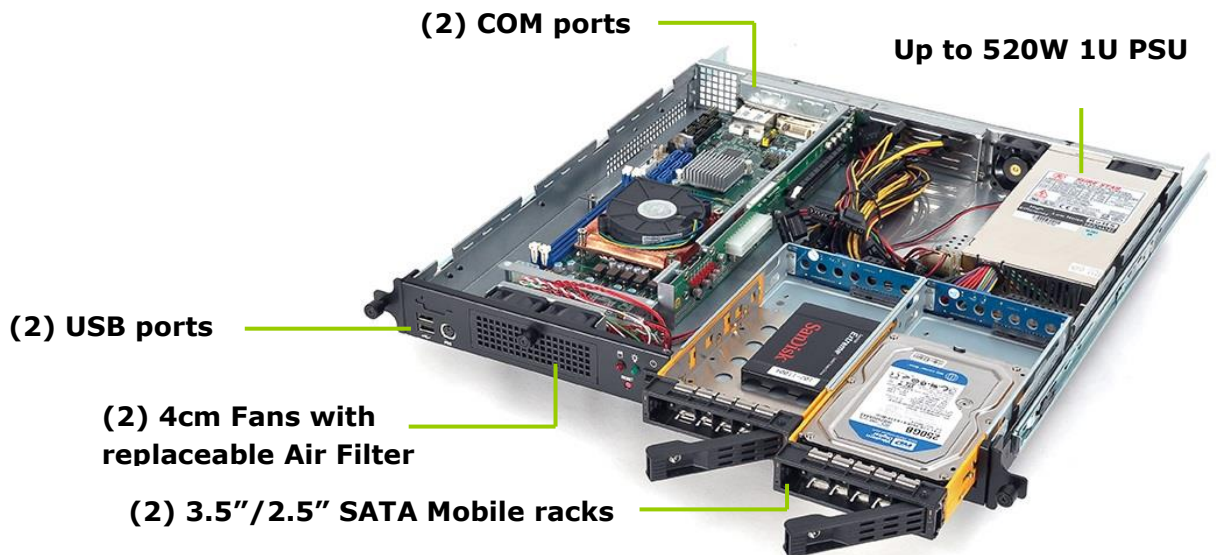

1U Rackmount Chassis for SBC board with 3 drive bays, PICMG 1.3 backplane, supports up to 520W PSU



Introduction

The **RCK-103BR1** is an extended version of RCK103BR with a depth of only 435.5mm, it provides an ideal solution for those applications where depth can make or break a project. The chassis is designed to support a PICMG 1.3/ 1.0 Backplane and SBC, the RCK-103BR1 proves to be a perfect choice for sub-racks and short rack cabinets. The RCK-103BR1 can support (2) hot swap 3.5"/2.5" and (2) 2.5" SATA drives. Additional I/O expansion can be easily configured through the (1) PCIe or (3) PCI slots on the PICMG backplane. Total of three 4cm ball-bearing fans ensure excellent airflow when faced with a heat sensitive application. The **RCK-103BR1** provides a robust solution to Firewall Server, Proxy Server, and VPN Gateway while still remaining compact.

Features

- Heavy-duty Steel construction with only 435.5mm in depth
- Supports full-size SCB through PICMG1.3 butterfly backplane
- (2) 3.5"/2.5" SATA mobile racks, (2) int. space for 2.5" HDD/SSD
- (2) USB and (1) PS/2 ports
- RS-232 port on front and rear panel
- (3) 4cm ball-bearing fans with replaceable air filter
- Support up to 520W 1U PSU
- Full extension Slide rail included



Mechanical Drawing

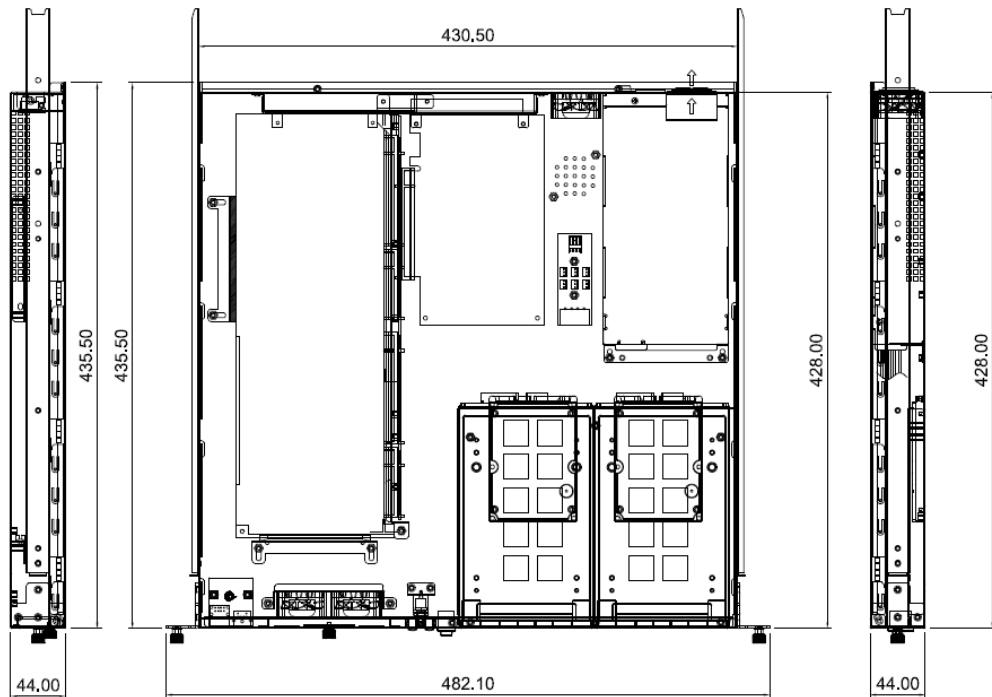

Construction

- Heavy-duty steel

Color

- Black

Board support

- Single Board Computer

Drive bays

- (2) 3.5"/2.5" SATA Mobile racks
- (2) internal space for 2.5" HDD/SSD

Expansion

- BPE-201E: Backplane with (1) PCIe x16 slot

Power Supply

- 300W/ 460W/ 520W 1U ATX PSU

Cooling System

- (3) 40mm ball-bearing fans with replaceable air filter

I/O Port

- (2) USB 2.0 port
- (1) front and (2) rear RS-232 port

Switch

- Power On/Off and Reset switches

Indicator

- Power On/Off and HDD activity LEDs

Operating temperature

- 0~55°C

Dimension (W x D x H)

- 430.5 x 435.5 x 44mm

Weight

- NW: 5kg / 11.1lbs
- GW: 8.8kg / 19.4lbs

Ordering Information

RCK-103BR1-RF-201E-BLK	1U chassis for SBC board with BPE-201E backplane
RCK-103BR1-RF-201E-300W-BLK	1U chassis for SBC board with BPE-201E backplane and 300W PSU
RCK-103BR1-RF-201E-460W-BLK	1U chassis for SBC board with BPE-201E backplane and 460W PSU