

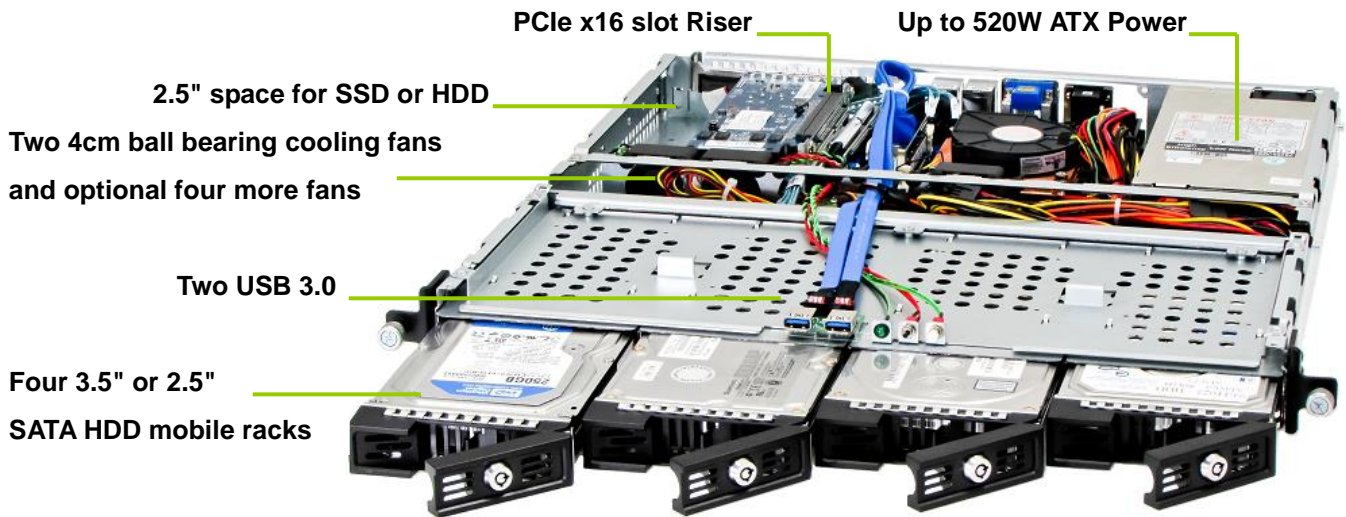

1U Rackmount Chassis with 4 Drive bays, supports Mini-ITX Motherboard , and up to 520W ATX Power supply



Introduction

The RCK-104M is a convenient design for 1U Rackmount Chassis to enables the integration of Firewall Server, Proxy Server, VPN Gateway system and etc.

RCK-104M ingenious mechanical design for the slim depth of 455mm which gives consideration to short dimension, superior heat dissipation up to six fan(4cm).

It is a compact slim chassis can accommodate FOUR HDD Mobile Racks for 3.5" or 2.5" SATA HDD and ONE 2.5" internal space for SSD or HDD to expand your storage capacity. Equipped to support Mini-ITX motherboard for core i3/i5/i7 processor. The RCK-104M proves to be a perfect choice for sub-racks and short rack cabinets.

Features

- Heavy duty steel construction with only 455 mm in depth
- Supports Mini-ITX motherboard
- (4) 3.5" or 2.5" SATA HDD mobile racks
- Support motherboard with onboard SAS port (with optional SAS cable)
- (1) 2.5" space for SSD or HDD
- (2) Front USB 3.0 ports
- (2) 4cm ball bearing cooling fans and optional four more fans
- PCIe x16 riser card
- Supports 1U up to 520W ATX power supply

Mechanical Drawing

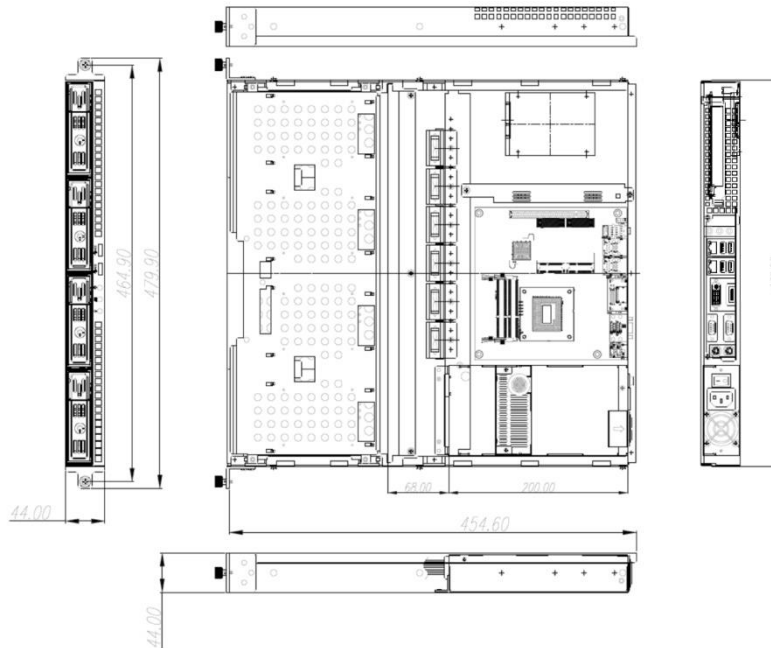

Construction

- 1.0 mm Heavy-duty steel

Color

- Silver

Board Support

- Mini-ITX motherboard

Drive Bays

- (4) 3.5" or 2.5" external Drive
- (1) 2.5" internal Drive bay
- Supports motherboard with onboard SAS port (with optional SAS cable)

Expansion

- (1) PCIe x16 slot

Power Supply

- 1U ATX power supply

Cooling System

- (2) 4cm ball bearing cooling fans
- (4) Extra space for additional 4cm fan

I/O Port

- (2) USB 3.0 on front panel

Switch

- On/Off Power Switch
- Reset Switch

Indicator LED

- Power On/Off Status
- HDD activity

Operating Temperature

- 0~55°C

Dimension (W x D x H)

- 430.5 x 454.6 x 44 mm
- 16.94 x 17.89 x 1.73 inch

Weight

- NW: 6.8kg / 15lbs
- GW: 8kg / 17.6lbs

Ordering Information

- | | |
|-----------------------|--|
| RCK-104M | 1U chassis for Mini-ITX motherboard with (4) 3.5" or 2.5" Drive bays and (1) 2.5" space |
| RCK-104M -300W | 1U chassis for Mini-ITX motherboard with (4) 3.5" or 2.5" Drive bays and (1) 2.5" space , and 300W ATX PSU |
| RCK-104M -460W | 1U chassis for Mini-ITX motherboard with (4) 3.5" or 2.5" Drive bays and (1) 2.5" space , and 460W ATX PSU |
| RCK-104M -520W | 1U chassis for Mini-ITX motherboard with (4) 3.5" or 2.5" Drive bays and (1) 2.5" space , and 520W ATX PSU |